

# THE WE HOTEL \_ JEJU

Aiving

STRICTLY CONFIDENTIAL (DISCUSSION PURPOSE ONLY)



# Contents

01 Asset Detail

02 Program Detail

03 Environment Analysis



01

Asset  
Detail



# The WE Hotel \_ Jeju

QUINTESSENTIALLY

Category	Details
Building Name	The WE Hotel (Premium Health Resort)
Location	453-95, 1100-ro, Seogwipo-si, Jeju-do 63551 Jeju Korea
Main Use	Complex facility [Medical Clinic + Tourist accommodation business + tourist use facility business]
Site Area	210,000m <sup>2</sup>
Gross Floor Area	16,167m <sup>2</sup>
Building Coverage Area	4,800m <sup>2</sup>
Building Scale	B1F – 6F
Date of Open	09 <sup>th</sup> February 2014
Number of Rooms	103 rooms (Superior rooms: 89, Deluxe rooms: 2, Suite rooms: 12)

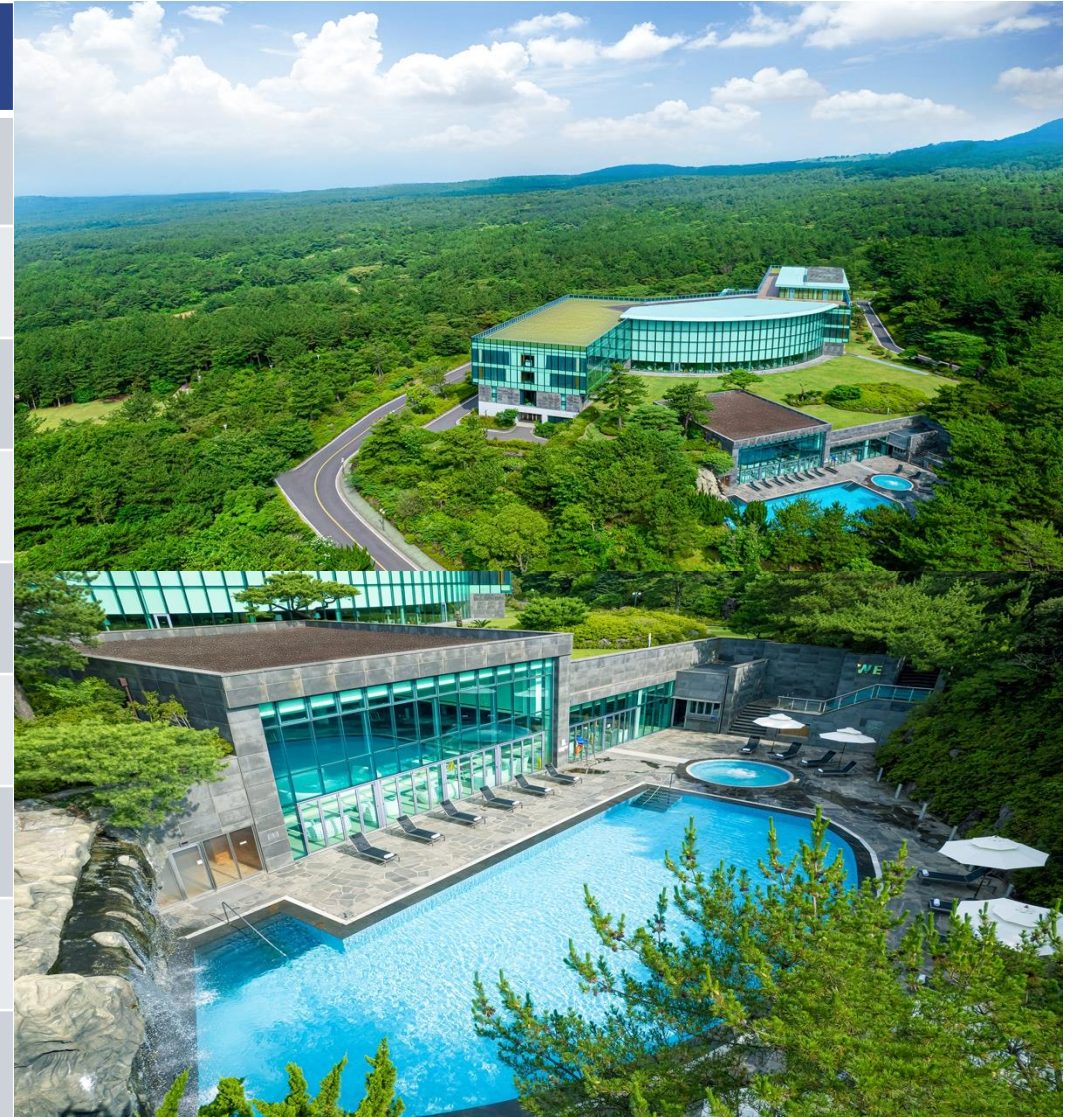

# The WE Hotel \_ Jeju

QUINTESSENTIALLY



The premium health resort "THE WE" is situated amidst the pristine forests of Hallasan in Seogwipo, Jeju Island—an area recognized by UNESCO for its natural heritage. It is Korea's first integrated healthcare resort developed under a medical tourism concept, combining the five-star WE Hotel with WE Hospital, operated by the Halla Medical Foundation.



- WE Hotel Jeju features 103 elegantly appointed guest rooms, offering a refined and tranquil ambiance with premium facilities. Nestled within an expansive site of approximately 210,000 square meters, the property is surrounded by a forest adorned with camellias, Jeju azaleas, hydrangeas, and rhododendron trees. Along its scenic trails, guests can enjoy leisurely one- to two-hour treks or nature walks, breathing in the refreshing air of Hallasan amidst a naturally preserved cypress forest.
- The resort utilizes natural volcanic bedrock water, rich in a variety of minerals, for drinking water, guest room showers, indoor and outdoor swimming pools, water-therapy pools, and spa facilities, offering a holistic wellness experience. Its wellness center, equipped with Korea's most advanced water-therapy infrastructure, is complemented by WE Hospital's Medical Spa Center, Health Promotion Center, and Beauty Center, providing a full range of anti-aging and personalized healthcare services.
- Guests can relax at the Azalea Bar or Azalea Lounge while enjoying signature Jeju cocktails, or savor a romantic and intimate dining experience at the All-Day Dining Restaurant "Dache", which offers natural-style wellness breakfast buffets, as well as Asian, Western, and traditional Jeju cuisine featuring fresh local seafood for lunch and dinner.



- From 2018 to 2021, WE Hotel Jeju was honored with the Tripadvisor Travelers' Choice Award for four consecutive years,
- Selected for the 2025 Travelers' Choice Award.
- In 2018, the hotel was ranked 13th among the Best Hotels in Korea and 1st in Jeju Island.



## Room Types \_ Superior Room

Q U I N T E S S E N T I A L L Y

**A Resting Space Embracing the Comfort of Nature:** A tranquil haven filled with Jeju's blue skies and warm sunlight, where natural wood textures and gentle tones create an atmosphere of serenity. Here, your own special journey of rest and rejuvenation begins.



### SUPERIOR ROOM

#### Room Features

- Panoramic Jeju View Through Full-Height Glass Windows
- Premium Interior with Subtle Wood Tones
- Spacious 31.5m<sup>2</sup> Layout
- Twin Bed Configuration (Double + Single)
- Comfortable Design Featuring 1 Bedroom and 1 Bathroom
- Standard Occupancy: 2 Adults / Maximum: 3 Guests

#### Complimentary Access to Premium Wellness Facilities

- Fitness Room
- Outdoor Jacuzzi
- Outdoor Finnish Sauna
- Indoor and Outdoor Swimming Pools

#### Room Location

- 3rd / 5th Floor
- Full-Height Glass Windows
- Scenic View Harmonizing with Jeju's Natural Landscape

# Room Types \_ Deluxe Room

Q U I N T E S S E N T I A L L Y

**Premium Space Embracing the Scenic Beauty of Jeju:** Experience a panoramic view through dual full-height glass windows, capturing the breathtaking landscapes and the essence of Jeju’s natural beauty at a glance.



DELUXE ROOM	
<b>Exceptional View</b>	<ul style="list-style-type: none"> <li>• Lush Pristine Forests</li> <li>• Majestic Mt. Songak and Mt. Sanbang</li> <li>• Enchanting Jeju Sunset</li> <li>• Tranquil Charm of Hallasan’s Mid-Mountain Region</li> <li>• Ever-Changing Ocean Scenery</li> </ul>
<b>Premium Room Configuration</b>	<ul style="list-style-type: none"> <li>• Spacious 43.5m² Layout</li> <li>• Comfortable King-Size Bed</li> <li>• Classic and Refined Interior Design</li> <li>• Well-Planned Layout with 1 Bedroom and 1 Bathroom</li> <li>• Standard Occupancy: 2 Adults / Maximum: 3 Guests</li> </ul>
<b>Room Location</b>	<ul style="list-style-type: none"> <li>• Corner Location on 3rd / 5th Floor</li> <li>• Dual Full-Height Glass Windows</li> <li>• Panoramic View Harmonizing with Jeju’s Natural Landscape</li> </ul>

## Room Types \_ Triple Suites

Q U I N T E S S E N T I A L L Y

**An Elegant Family Retreat:** Enjoy a refined and relaxing stay with your loved ones in a spacious setting. Create unforgettable memories and experience the perfect family getaway in our Triple Suite.



### TRIPLE SUITES

#### Spacious Layout Design

- Generous 64.3m<sup>2</sup> Floor Area
- Two Separate Private Bedrooms
- Scenic Family Living Room with a View
- One Bathroom and One Restroom for Convenience
- Equipped with a Classic Dressing Table

#### Premium Bedding Arrangement

- Comfortable King-Size Bed (Bedroom 1)
- Practical Twin Beds (Bedroom 2)
- Spacious Accommodation for up to 4 Adults

#### Distinctive Value

- Beautiful Garden View
- Premium Location on 3rd / 5th Floor
- Elegant Classic Interior
- Family-Friendly Spatial Design

# Room Types \_ Superior Suites

Q U I N T E S S E N T I A L L Y

**A Premier Retreat Embraced by Nature:** Experience ultimate comfort in an exclusive suite featuring separate bedrooms, where panoramic views of lush forests and serene gardens unfold before you.



SUPERIOR SUITES	
<b>Premium Spatial Composition</b>	<ul style="list-style-type: none"> <li>• Spacious 69.2m<sup>2</sup> Layout</li> <li>• Separate Design Featuring an Independent Bedroom and a Large Living Room</li> <li>• One Bathroom and One Restroom for Added Convenience</li> <li>• Comfortable King-Size Bed</li> <li>• Occupancy: 2 Adults and 1 Child</li> </ul>
<b>Distinctive Value</b>	<ul style="list-style-type: none"> <li>• Private and Exclusive Space Ensuring Complete Privacy</li> <li>• Beautiful Garden View Surrounded by Forests</li> <li>• Premium Location on 3rd / 5th Floor</li> <li>• Luxurious Interior in Harmony with Nature</li> </ul>
<b>Differentiated Experience</b>	<ul style="list-style-type: none"> <li>• Expansive Windows Overlooking a Lush Garden</li> <li>• Relaxing Tea Time in the Comfort of the Living Room</li> <li>• A Tranquil Retreat Offering Complete Privacy</li> </ul>

## Room Types \_ Parlor Suites

Q U I N T E S S E N T I A L L Y

**Premium Space Capturing the Panoramic Beauty of Jeju:** With its expansive views and sophisticated spatial design, this suite perfectly embodies the radiant moments and natural splendor of Jeju.



### PARLOR SUITES

#### A Space That Inspires Emotion

- Spacious 68.5m<sup>2</sup> Suite
- Efficient Layout with Separate Bedroom and Living Room
- Panoramic View Showcasing the Beauty of Jeju
- Private Design Featuring One Bathroom and One Restroom
- Comfortable King-Size Bed

#### Extraordinary Experience

- Morning Filled with Jeju's Gentle Sunlight
- Sense of Openness in Harmony with Nature
- Leisure and Relaxation Enjoyed from the Living Room
- A Perfect Harmony of Comfort and Luxury

#### Exceptional Value

- Premium 3rd-Floor Location
- Standard Occupancy: 2 Adults / Maximum: 3 Guests
- Refined Interior with Elegant Furnishings
- Optimized Spatial Layout for Comfort and Convenience

## Room Types \_ Royal Suites

Q U I N T E S S E N T I A L L Y

**The High-End of The WE Hotel \_ Jeju:** Embrace the ultimate retreat in an exclusive space where the sky and land of Jeju create the island's most breathtaking scenery. Here, amidst the magnificent views of sunrise and sunset, your journey toward perfect relaxation begins.



### ROYAL SUITES

#### Breathtaking View

- Premium 5th-Floor Location
- Majestic View of Hallasan Mountain
- Endless Horizon of the Jeju Sea
- Panoramic Full-Height Glass Windows
- Spectacular Sunrise and Sunset to Begin and End Your Day

#### Ultimate Luxury Space

- Spacious 97.4m<sup>2</sup> Layout
- Elegant Interior with Premium Furnishings
- Private Dining Area
- Separate Living Room and Bedroom
- Comfortable King-Size Bed
- Luxurious Bathroom and Powder Room

#### Extraordinary Experience

- Private Dining Experience in the Dining Room
- Enjoy Jeju's Changing Seasons from the Living Room
- Complete Privacy on the Top Floor
- Standard Occupancy: 2 Adults / Maximum: 3 Guests

# Room Types \_ Oxygen Room [For Wellness]

Q U I N T E S S E N T I A L L Y

**A Healing Space Filled with the Pure Air of Hallasan:** Experience deep rest and complete rejuvenation in a purpose-designed wellness room that recreates the refreshing atmosphere of Hallasan’s pristine forest air.



OXYGEN ROOM (FLOOR KING & FLOOR TWIN)	
<b>Specially Designed for Restful Sleep</b>	<ul style="list-style-type: none"> <li>• Maintains the Same Oxygen Concentration as Hallasan’s Forest</li> <li>• Nightly Three-Hour Oxygen Care from 10 PM</li> <li>• Perfectly Sealed System for Optimal Oxygen Levels</li> <li>• Spacious Rooms: 46.3m<sup>2</sup> (Floor King) &amp; 31.5m<sup>2</sup> (Floor Twin)</li> </ul>
<b>Premium Interior Design</b>	<ul style="list-style-type: none"> <li>• Harmonious Blend of Modern Korean and Western Design</li> <li>• Comfortable King-Size Bed</li> <li>• Well-Appointed Bathroom Facilities</li> <li>• Standard Occupancy: 2 Adults / Maximum: 3 Guests</li> </ul>
<b>Distinctive Wellness Experience</b>	<ul style="list-style-type: none"> <li>• Restful Sleep Care through Oxygen Therapy</li> <li>• Pristine Air Reminiscent of Hallasan’s Forest</li> <li>• Complete Escape from Urban Noise and Pollution</li> <li>• Private Space Designed for Total Relaxation</li> </ul>

# Main Facilities I

QUINTESSENTIALLY



**OUTDOOR POOL**



**OUTDOOR ZACUZZI**



**OUTDOOR DRY SAUNA**



**INDOOR POOL**



**SAUNA**



**FITNESS CENTRE**

## Main Facilities II

QUINTESSENTIALLY



**ALL DAY DINING - DACHAE**



**AZALEA BAR**



**ROOFTOP BAR - DELLA**



**AZALEA LOUNGE**



**DELI**



**ROOFTOP TERRACE - TRÈ**

# Main Facilities III

QUINTESSENTIALLY



**EMERALD HALL**



**VIP MEETING ROOM**



**GEUMHO GARDEN**



**JADE ROOM**



**BUSINESS CENTRE**



**AZALEA GARDEN**

02

# Program Detail



# [WE Hospital] 1:1 Personalized One-Stop Care Program

QUINTESENTIALLY

**Personalized Wellness Journey:** Through in-depth one-on-one consultations with medical specialists, each guest's lifestyle and health condition are thoroughly analyzed to design a customized premium wellness program tailored to individual needs.

## Health Promotion Centre



- Types of Medical Examinations: Organic Acid Test, Intestinal Microbiome Test, Genetic Test, Mineral and Heavy Metal Test, Active Oxygen and Antioxidant Capacity Test, Antioxidant Vitamin and Mineral Test, Vitamin D Test, Blood Viscosity Test, Cardiovascular and Cerebrovascular Disease Risk Test, Acute Allergy Test, Atopy Test, Food Intolerance (Delayed Hypersensitivity) Test, Autoantibody (Autoimmune) Test, NK Cell Activity Test, Fatty Acid Test, Amino Acid Test, Dementia Risk Assessment, and Hormone Test.
- Following a one-on-one wellness consultation with a medical specialist, clients undergo the necessary health examinations tailored to their individual conditions. Based on the results, a personalized wellness program is developed, along with a customized nutritional plan co-designed by medical specialists and the hotel's five-star chefs.

## Beauty Centre



- Surgical Procedures: Eyelid Surgery, Rhinoplasty, Facial Lifting Surgery, Double Thread Lifting, Liposuction, and Fat Grafting.
- Petti Aesthetic Procedures: Filler Injections, Botox, Skin Booster Injections, AirJet Treatments, Contouring and Lipolysis Injections, and PRP (Platelet-Rich Plasma) Therapy.
- Skin Laser Programs: Laser Toning, A-Tone, CO<sub>2</sub> Laser, Fractional Laser, Ulthera Lifting, Shurink Lifting, 3DEEP RF Lifting, Vanquish, and RF (Radio Frequency) Treatments.

# [Wellness Centre] Wellness Centre Program

QUINTESSENTIALLY

**[Water Zone] Hydro-Therapy Program:** Enjoy a variety of water-based therapy programs designed to match each guest's individual physical condition and wellness goals, providing a deeply personalized and rejuvenating healing experience.

## Aqua Meditation Pool



- While floating on the water with the aid of a buoyancy device, guests experience stretching and acupressure therapy that promote mental relaxation, muscle tension relief, stress reduction, and improvement in mood and sleep quality.
- The water is maintained year-round at a neutral temperature between 34°C and 37°C, and underwater speakers are installed to allow guests to enjoy soothing music throughout the session, enhancing the overall therapeutic effect.

## Aqua Circuit

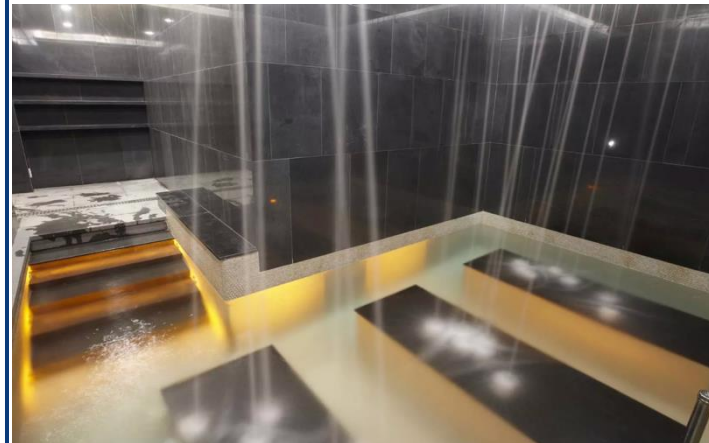

- This program involves rotational use of multiple functional pools, each selected according to the guest's physical condition and therapeutic goals. The treatment promotes metabolism activation, enhanced skin elasticity, and muscle strengthening and relaxation.
- Functional Pools: Water Stone, Ultrasonic, Micro Bubble Aqua, Aqua Gym, Dream Bath, and Water Treatment Pool.

## Miracle Water



- Using premium natural bicarbonate water (O-index 5.9), this therapy helps neutralize active oxygen, promote fatigue recovery, improve blood circulation to relieve cold extremities, and enhance digestion and detoxification.
- In daily wellness routines, detox juices and tea therapies made from natural volcanic bedrock water further support skin rejuvenation, antioxidant and anticancer benefits, and prevention of lifestyle-related diseases.

## [Wellness Centre] Wellness Centre Program

QUINTESENTIALLY

**[Water Zone] Hydro-Therapy Program:** Enjoy a variety of water-based therapy programs designed to match each guest's individual physical condition and wellness goals, providing a deeply personalized and rejuvenating healing experience.

### Aqua Movement



- By utilizing the gentle resistance of water, this program helps relax and loosen muscles stiffened overnight.
- Under the guidance of professional instructors, guests can engage in a variety of aquatic exercises designed to energize the body and mind, providing a refreshing start to the day.

### Aqua Calming



- Immerse yourself in mineral-rich natural volcanic bedrock water, where the underwater sounds blend harmoniously with the vibrations of Himalayan singing bowls resonating above the surface, creating a deeply soothing effect that relieves muscle tension.
- Guided by professional instructors, guests are led into a state of focused underwater meditation, promoting mind-body balance and profound relaxation.

## [Wellness Centre] Wellness Centre Program

QUINTESENTIALLY

**[Land Zone] Healing Forest & Meditation Therapy Program:** Situated at an elevation of 350 meters on the mid-slope of Hallasan Mountain, WE Hotel Jeju offers exclusive forest healing and meditation therapy programs within Jeju's pristine, living forest environment. Guests can experience specialized wellness therapies uniquely designed for this premium health resort, harmonizing the healing power of nature with holistic well-being.

### Healing Forest



- The <Healing Forest> Program offers guided experiences led by professional instructors who share insightful stories about the forest and its natural ecosystem.
- Guests can participate in a personalized forest-healing tour featuring activities such as color therapy inspired by nature, forest play sessions (<Forest Play>), and <Forest Healing>, which includes meditation and stretching exercises amidst a phytoncide-rich forest environment, promoting deep relaxation and mental clarity.

### Mind Therapy



- The Sound Therapy Program utilizes the Crystal Singing Bowl, made of 99.9% natural crystal, to generate healing vibrations and frequencies that enhance the body's cellular regeneration and self-healing ability, while also aiding in the treatment of insomnia and stress relief.
- Guests can also experience light therapy using fiber-optic illumination and color therapy with warm-toned color balls, creating a multi-sensory healing environment that restores balance to both body and mind.

## [Medical Spa] Medical Spa Centre Program

QUINTESSENTIALLY

Using premium spa brand products, WE Hotel Jeju offers specialized body and facial treatments designed to enhance immunity, support joint and pain management, and improve cognitive function. The resort also features exclusive Hydro Therapy programs utilizing natural volcanic bedrock water rich in bicarbonate, vanadium, selenium, magnesium, and other beneficial minerals unique to Jeju's pristine environment. Professional spa therapists curate personalized wellness programs tailored to each guest's preferences and physical condition, delivering the ultimate relaxation experience and the finest standard of spa service in a world-class healing environment.

### Skincare

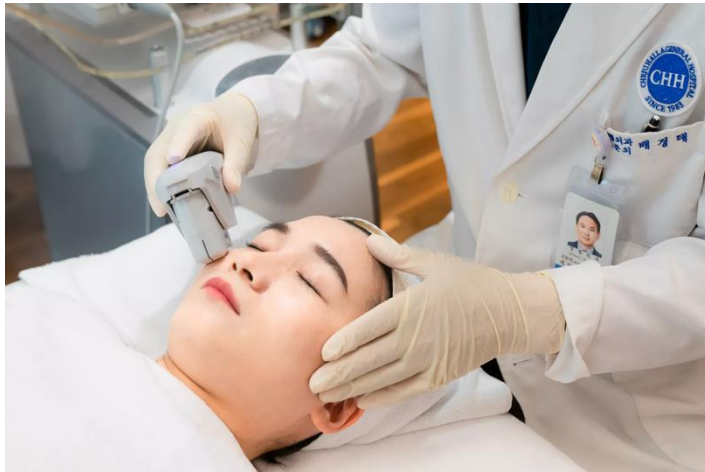

Through state-of-the-art equipment combined with advanced manual therapy techniques, the skin is rejuvenated, the body regains vitality, and guests experience effective results in anti-aging, detoxification, and circulation enhancement.

### Vichy Shower

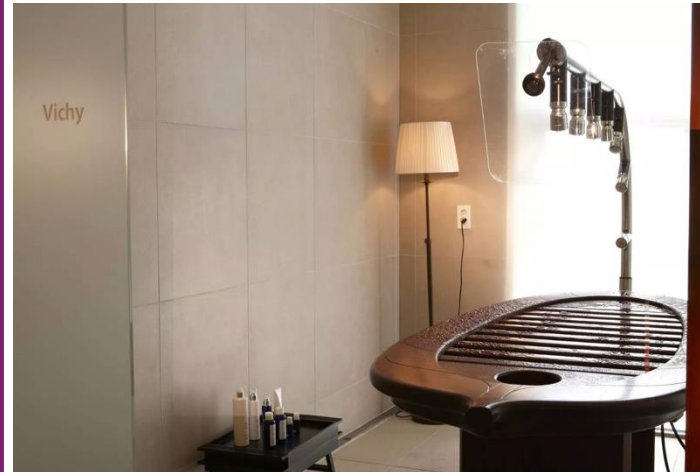

Experience perfect healing through eight streams of water, offering an ideal balance of enhanced blood circulation and muscle relaxation, effectively relieving everyday fatigue.

### Hydroton



With customized water streams from 300 precision nozzles, this treatment helps eliminate toxins, improve blood circulation, and provides a perfect wellness solution for everyone—from seniors to those seeking post-exercise recovery.

## [Medical Spa] Medical Spa Centre Program

QUINTESSENTIALLY

Using premium spa brand products, WE Hotel Jeju offers specialized body and facial treatments designed to enhance immunity, support joint and pain management, and improve cognitive function. The resort also features exclusive Hydro Therapy programs utilizing natural volcanic bedrock water rich in bicarbonate, vanadium, selenium, magnesium, and other beneficial minerals unique to Jeju's pristine environment. Professional spa therapists curate personalized wellness programs tailored to each guest's preferences and physical condition, delivering the ultimate relaxation experience and the finest standard of spa service in a world-class healing environment.

### Hyperthermia

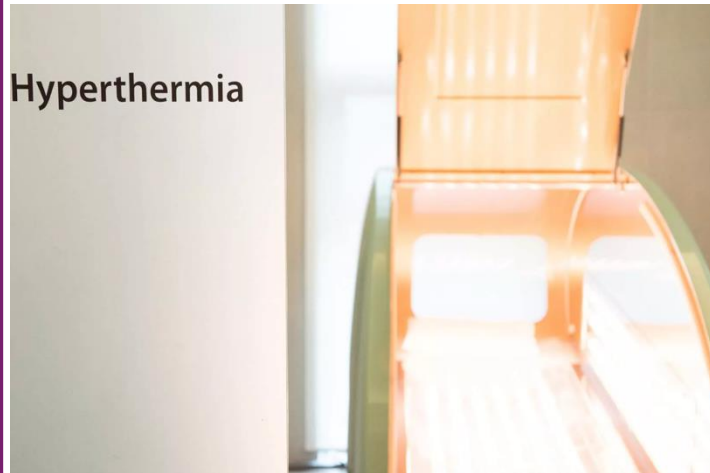

Using innovative wIRA (water-filtered infrared-A) thermal therapy, which filters infrared rays through water, this treatment raises core body temperature, thereby enhancing immunity, relieving overall body pain, eliminating toxins, and promoting anti-aging effects.

### Carbon treatment



Using advanced carbon technology, ultra-fine carbonated microbubbles penetrate deep into the skin, simultaneously enhancing blood circulation and improving overall skin condition for visible rejuvenation effects.

### Vabro



Through a harmonious blend of Jeju's natural herbs and far-infrared steam, this treatment deeply nourishes the skin, promotes blood circulation, and simultaneously delivers detoxification and purification effects for radiant, healthy skin.

**03**

**Environment  
Analysis**



## Why Jeju?

QUINTESENTIALLY

Jeju Island is designated as an International Free Economic Zone—the only region in Korea where pristine nature, free entry and exit, and integrated industries of medical, wellness, and tourism coexist, forming a unique special economic, ecological, and cultural hub.

- ✓ Visa-Free Entry System: Foreign visitors may stay in Jeju for up to 30 days without a visa when entering through Jeju International Airport or designated ports.
- ✓ Foreign Ownership and Investment Residency: Foreign land acquisition is legally permitted, and the Investment Immigration Program (Property-Based F-2 Visa) is applicable.
- ✓ Jeju Free International City (JDC) Projects: With large-scale integrated developments combining tourism, healthcare, education, and advanced industries, Jeju offers tax benefits and incentives comparable to those of free economic zones, promoting active foreign investment.

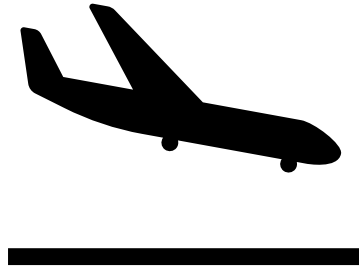

### Rising Demand from Foreign Visitors Driven by the Visa-Free Entry Policy

In 2024, Jeju Island recorded a total of approximately 13,783,911 visitors, of which 1,907,608 were foreign tourists — representing a year-on-year increase of about 169.6%.

### Growing Foreign Demand for Real Estate Investment Immigration in Jeju

Foreigners collectively own approximately 21.79 million square meters of land in Jeju, accounting for about 1.17% of the island's total land area, along with an estimated 1,754 housing units held under foreign ownership.

### Rising Demand for Foreign Medical Tourism in Jeju

In 2024, Jeju recorded a 221.0% increase in the number of foreign patients, the highest growth rate among all non-capital regions in Korea. The number of foreign patients seeking dermatology treatments in Jeju rose by 781.4% year-on-year.

## Nature & Wellness Infrastructure

QUINTESSENTIALLY

Within a 20-minute drive lies the Yeongsil Trail, renowned as one of Korea's most beautiful routes for climbing Hallasan Mountain. Additionally, major attractions such as Cheonjiyeon Waterfall, Jusangjeolli Cliff, Saekdal Beach, and popular Hallasan trekking routes including the Hallasan Dulle-gil Trail, as well as Soesokkak Estuary, are all located within a 10- to 30-minute distance from the resort.



**Cheonjiyeon Waterfall**



**Jusangjeollie Cliff**



**Saekdal Beach**



**Yeongsil Trail**



**Soesokkak Estuary**



**Hallasan Dulle-gil Trail**

# Sport Infrastructure

Q U I N T E S S E N T I A L L Y

Within a 10-kilometer radius of THE WE Hotel \_ Jeju, there are four premium golf courses, catering perfectly to the leisure and lifestyle demands of VIP guests.

- ✓ High-Value Mixed-Use Location Combining Medical, Golf, and Wellness Industries: A prime destination integrating medical, golf, and wellness sectors—offering a high-value ecosystem essential for attracting affluent foreign investors, high-net-worth individuals, and VIP clientele.
- ✓ The area provides exceptional potential for synergistic premium wellness programs, such as VIP sports retreat packages at luxury golf courses, clubhouse social events, and golf-linked membership programs, all designed to deliver an exclusive and holistic leisure experience.

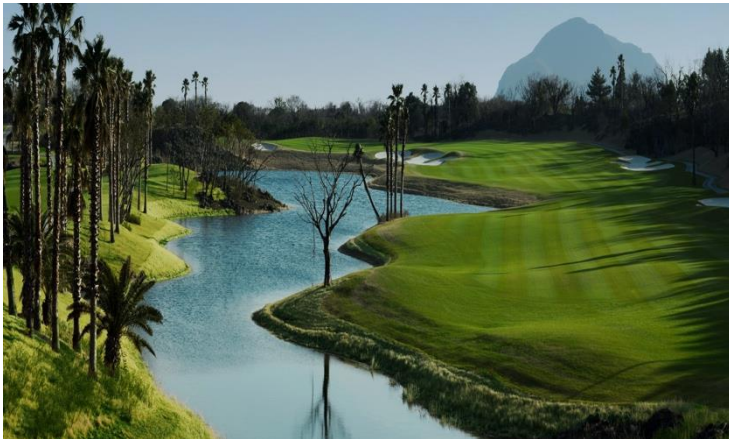

## Teddy Valley CC

Scale: 18-Hole

Recognized as one of the Top 10 Golf Courses in Korea, Teddy Valley CC is located within the Jungmun-Seogwipo tourism belt, harmoniously integrated with surrounding resort and leisure facilities, making it an ideal destination for premium resort-style golf and relaxation.



## Lotte Sky Hill CC

Scale: 36-Hole

A nature-friendly golf course offering panoramic views of the Seogwipo coastline, Mt. Sanbang to the south, and Mt. Hallasan to the north. Designed by Robert Trent Jones Jr. (RTJ), one of the world's most renowned golf course architects, the course harmonizes Jeju's unique volcanic landscape.



## Jungmun CC

Scale: 18-Hole

Designed along the coastal cliffs, the course offers stunning oceanfront scenery and a marine climate that allows for comfortable year-round play, even during the winter season.



## Pinx CC

Scale: 18-Hole

Located along Sanroknam-ro in Andeok-myeon, Seogwipo, the course sits on an elevated hillside terrain boasting exceptional natural scenery and a picturesque landscape that perfectly embodies Jeju's pristine environment.

# Jeju Halla General Hospital

Operated by Halla Medical  
Foundation



# Jeju Halla General Hospital

Category	Details
Established in	Oct. 1983
Operating Corporation	Halla Medical Foundation
Founder	Byeng-chan Kim
Location	65, Doryeong-ro, Jeju-si, Jeju-do, South Korea
Type	General Hospital
Scales	B2 -10F (Two Main Buildings)
Medical Departments	26 departments
Number of doctors	126 doctors
Emergency System	Regional Emergency Medical Center & Regional Trauma Center & Doctor-Helicopter Service
Hospital Beds	587 beds



## Medical Departments Details

Internal Medicine (Gastroenterology, Cardiology, Nephrology, Endocrinology, Hematology-Oncology, Pulmonology, Infectious Diseases, Rheumatology), General Surgery, Obstetrics & Gynecology, Rehabilitation Medicine, Orthopedic Surgery, Pediatrics, Radiation Oncology, Neurosurgery, Ophthalmology, Anesthesiology & Pain Medicine, Thoracic Surgery, Otorhinolaryngology, Diagnostic Radiology, Plastic Surgery, Urology, Laboratory Medicine, Neurology, Nuclear Medicine, Psychiatry, Pathology, Dentistry, Health Management, Family Medicine, and Emergency Medicine.

*\*The hospital is being developed into a specialized medical institution with expanded Cancer and Cardiovascular Centers, enabling comprehensive organ transplant surgeries, including open-heart surgery, across all advanced medical disciplines.*

# Halla Medical Foundation

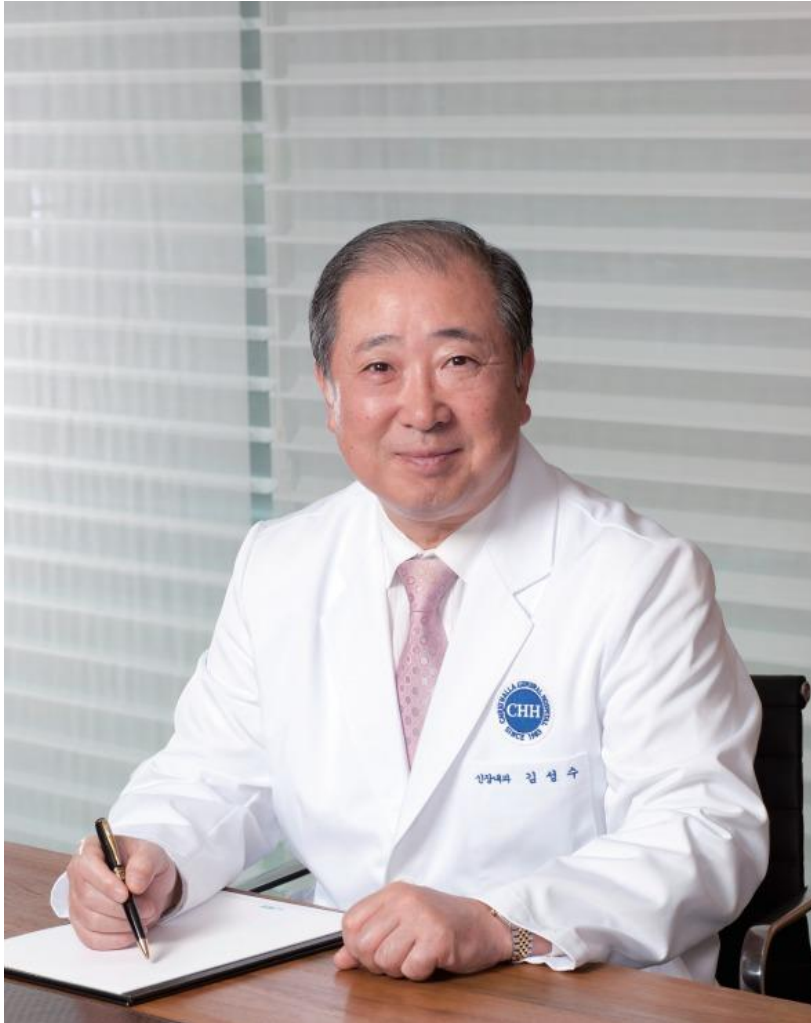

## Sung-Soo Kim, Chairman

President, Jeju Halla General Hospital

2nd Chairman, Halla Medical Foundation

Graduated from Chung-Ang University  
College of Medicine

Master's Degree, Chung-Ang University  
Graduate School of Medicine

Formerly) Director, Department of  
Nephrology, Jeju Halla General Hospital

President, Jeju Medical Association

Executive Director, Korean Hospital  
Association

Vice Chairperson (Three Terms), Jeju Chapter  
– National Unification Advisory Council

Recipient of the Presidential Commendation  
and the Order of Civil Merit, Moran Medal

**Halla Medical Foundation**

**Business Scope**

**Jeju Halla General Hospital**

**THE WE Hospital**

**THE WE HOTEL \_ JEJU**



**WE HOSPITAL**

**THE WE**  
PREMIUM HEALTH RESORT



# Contacts

**이진선 (Jinsun Lee)**

CEO, Aiving Co., Ltd.

+8210 5180 3929

[sun@aiving.sg](mailto:sun@aiving.sg)

**김연혁 (Harvey Kim)**

CEO, Weekly Aiving Co., Ltd.

+8210 4106 8286

[harvey@weeklyaiving.com](mailto:harvey@weeklyaiving.com)